

January 2, 1992
BT:sc

INTRODUCED BY: RON SIMS

PROPOSED NO.: 92-6

MOTION NO. 8509

A MOTION authorizing the executive to grant a utility easement for a fire hydrant to the City of Seattle in Council District No. 5.

WHEREAS, under King County Code 4.56.010 the King County council may authorize the King County executive to grant an easement through county property, and

WHEREAS, the City of Seattle installed a fire hydrant for the King County department of public works, airport division, in order to provide fire protection service to the airport's control tower facilities, and

WHEREAS, the City of Seattle requires that the county grant a utility easement for a fire hydrant as a condition of operating and maintaining this system, and

WHEREAS, the department of public works, airport division, has requested that a utility easement for a fire hydrant be granted to provide fire protection to the airport control tower facilities, and

WHEREAS, the department of public works, airport division, finds that the granting of this utility easement will not interfere with the use of this property and that the rights requested by the City of Seattle are surplus to the county's present and foreseeable needs, and

WHEREAS, the King County council finds that the easement would be in the best interests of the citizens of King County;

NOW, THEREFORE, BE IT MOVED by the Council of King County:

The county executive is authorized to sign and deliver a utility easement for a fire hydrant and all necessary appurtenances substantially in the form of the attached Exhibit "A" for the following described property.

1 Easement area being an area 8 feet by 8 feet encumbering 64
square feet of area, more particularly described as,

2 An irregular-shaped tract of land between the main runway on
3 King County International Airport and East Marginal Way, in the
NE 1/4 of the NW 1/4 of Section 33, Township 24 North, Range 4
4 East, Willamette Meridian, described as follows:

5 Beginning at a concrete monument designated as Monument "D" and
6 having U.S. Coast and Geodetic Survey coordinate values of X =
7 1,637,871.14, Y = 105,531.46; then South 72°48'11" West 229.73
8 feet to the intersection of a line parallel with and 425.00 feet
9 Southwesterly from the centerline of the aforementioned runway;
10 THENCE North 53°06'55" West a distance of 42.59 feet to a point
11 on the centerline of a chain-link fence;
12 THENCE North 28°42'13" West along the centerline of the chain-
13 link fence which is parallel with the centerline of Runway
14 13R/31L a distance of 1199.27 feet;
15 THENCE South 62°54'55" West a distance of 211.70 feet to a point
lying on the Easterly margin of East Marginal Way South;
16 THENCE Southerly along said Easterly margin following a curve to
17 the right with a radius of 2,928.00 feet, an arc distance of
27.00 feet to the TRUE POINT OF BEGINNING;
18 THENCE North 62°54'54" East a distance of 8.00 feet;
19 THENCE North 28°42'13" West a distance of 8.00 feet;
20 THENCE South 62°54'55" West a distance of 8.00 feet;
21 THENCE Southerly along the Easterly margin of East Marginal Way
22 South an arc distance of 8.00 feet, more or less to the TRUE
23 POINT OF BEGINNING; (said tract of land contains an area of 64
24 square feet).

25 (For a hydrant to be installed approximately 245 feet
26 southeasterly of the north line of the J. Buckley Donation Land
27 Claim No. 42 as measured along the easterly margin of East
28 Marginal Way South.)

29 PASSED this 10th day of February, 19 92.

30 KING COUNTY COUNCIL
31 KING COUNTY, WASHINGTON

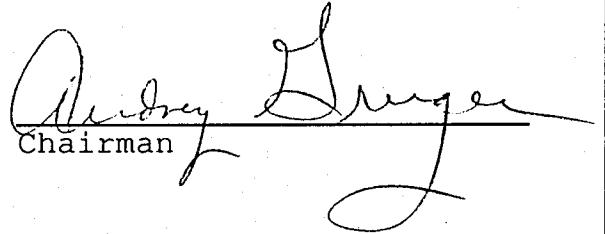
32 
33 Chairman

34 ATTEST:

35 
36 Clerk of the Council

72W

M.C.

M.C.

200' x 100'

King County

International

Air

Gov't. Lot 12

27.47 AC.

JOHN BUCKLEY DIVISION LAND CLAIM NO. 42

ROSE ST. EXT'D

E A N O G

CONTROL TOWER

BOEING

LANDSCAPE AREA WITH JUNIPERS 3' O.C.

EXTRUDED CONC. CURBING

WATER METER #2159952

3" ECA 4" SS

3" ECA 1 1/2" WATER

3/4" GAS

HYD

ASPHALT

EX 4" x 4" WOOD SIGN POST (STOP SIGN)

FIRE HYDRANT LOCATION

SITE LOCATION

CONTROL TOWER (8200)

3" ECA

211.70' S 62° 5'

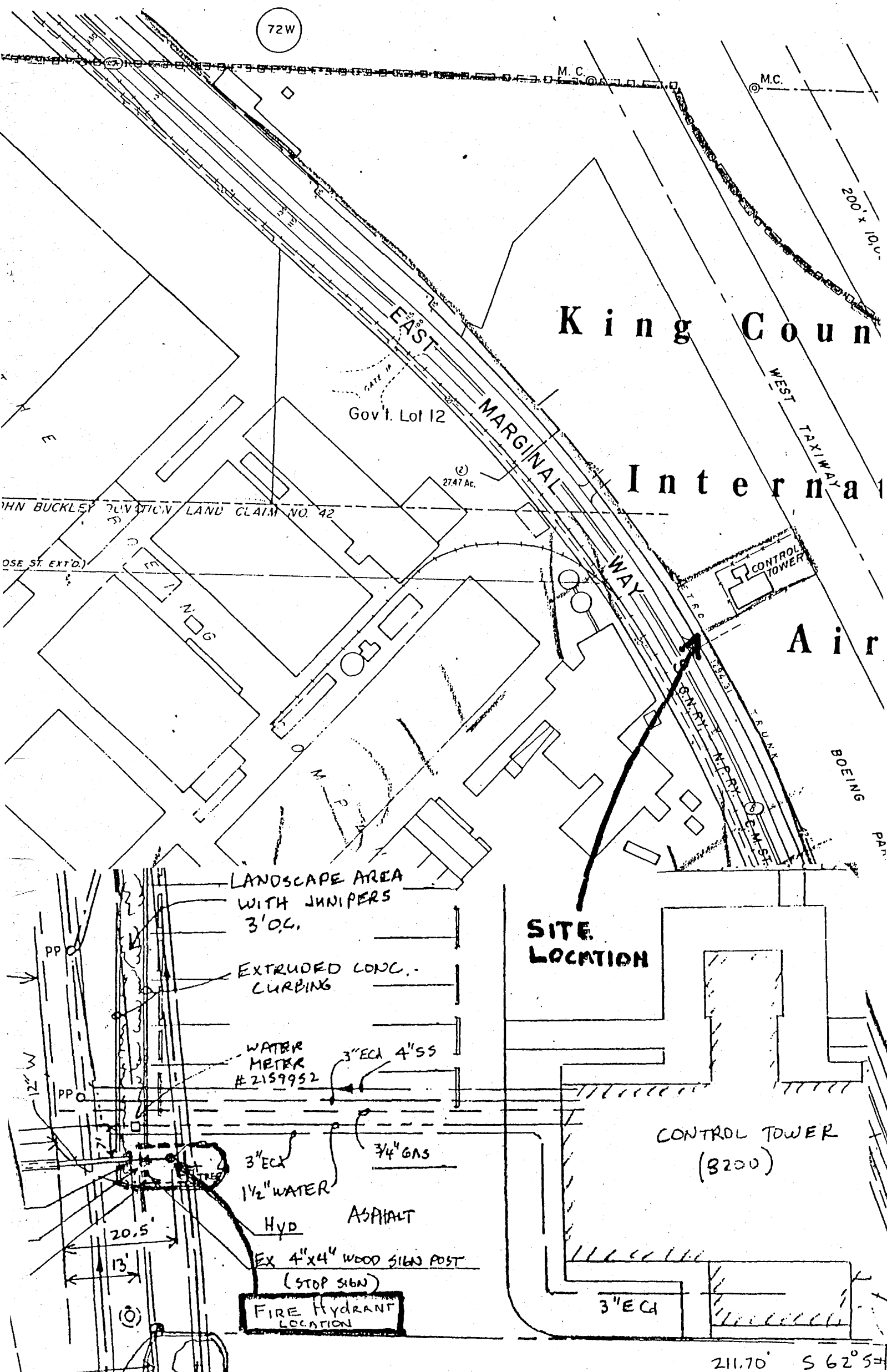

EASEMENT FOR A HYDRANT

The Grantor, KING COUNTY, a municipal corporation of the State of Washington for and in consideration of one dollar ((\$1.00) the receipt of which is hereby acknowledged, hereby conveys to

The Grantee, THE CITY OF SEATTLE, a municipal corporation of the State of Washington,

An easement for a hydrant and appurtenances, including connecting water service pipes, over, across and along the following described real property in King County, Washington for the construction, reconstruction, alteration, operation, maintenance and repair of the aforesaid water service facilities.

Description:

An irregular-shaped tract of land between the main runway on King County International Airport and East Marginal Way, in the NE 1/4 of the NW 1/4 of Section 33, Township 24 North, Range 4 East, Willamette Meridian, described as follows:

Beginning at a concrete monument designated as Monument "D" and having U.S. Coast and Geodetic Survey coordinate values of X = 1,637,871.14, Y = 105,531.46; then South 72°48'11" West 229.73 feet to the intersection of a line parallel with and 425.00 feet Southwesterly from the centerline of the aforementioned runway;
 THENCE North 53°06'55" West a distance of 42.59 feet to a point on the centerline of a chain-link fence;
 THENCE North 28°42'13" West along the centerline of the chain-link fence which is parallel with the centerline of Runway 13R/31L a distance of 1199.27 feet;
 THENCE South 62°54'55" West a distance of 211.70 feet to a point lying on the Easterly margin of East Marginal Way South;
 THENCE Southerly along said Easterly margin following a curve to the right with a radius of 2,928.00 feet, an arc distance of 27.00 feet to the TRUE POINT OF BEGINNING;
 THENCE North 62°54'54" East a distance of 8.00 feet;
 THENCE North 28°42'13" West a distance of 8.00 feet;
 THENCE South 62°54'55" West a distance of 8.00 feet;
 THENCE southerly along the easterly margin of East Marginal Way South an arc distance of 8.00 feet, more or less to the TRUE POINT OF BEGINNING; (said tract of land contains an area of 64 square feet).

(For a hydrant to be installed approximately 245 feet southeasterly of the north line of the J. Buckley Donation Land Claim No. 42 as measured along the easterly margin of East Marginal Way South.)

Grantee or its agents shall have the right without prior institution of any suit or proceeding at law, at such times as may be necessary, to enter upon said easement area for the purposes herein described, provided that such work shall be accomplished in such a manner that the private improvements existing in said working area shall not be disturbed or destroyed, or in the event that they are disturbed or destroyed, they shall be replaced in as good condition as they were immediately before the property was entered upon the by City.

Grantor shall have the right to use said property in any way and for any purpose not inconsistent with the rights herein granted.

EXHIBIT 'A'

Grantor hereby agrees that no building, fence, wall, rockery, trees, shrubbery or obstruction of any kind shall be erected or planted, or any fill material placed within the boundaries of said easement area without the written permission of the City of Seattle's Superintendent of Water, which said permission shall not be unreasonably withheld and that no excavation shall be made within three feet of said water service facilities and that the surface level of the ground within the easement area shall be maintained at the same elevation as the base of the hydrant.

This agreement and each of the terms, provisions, conditions and covenants herein shall be binding upon and inure to the benefit of the parties hereto and their respective successors and assigns, and shall run with the land.

Dated this _____ Day of _____ 19____

GRANTOR
KING COUNTY, WASHINGTON

BY: _____
Tim Hill, King County Executive

APPROVED AS TO FORM:

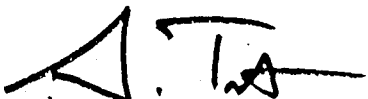
BY:  _____
Deputy Prosecuting Attorney
12.3.91

STATE OF WASHINGTON)
) ss.
COUNTY OF KING)

I certify that _____ signed this instrument, on oath stated that he was authorized by the King County Executive to execute the instrument, and acknowledged it as the _____ of King County, Washington to be the free and voluntary act of said County for the uses and purposes mentioned in the instrument.

NOTARY PUBLIC in and for the State of Washington,
residing at _____
My appointment expires _____

EXHIBIT 'A'